



No	Part Name	Material
01	Body	GGG40 - GGG50
02	Cover	GGG40 - GGG50
03	Handwheel	GG25
04	Slider guide	P.O.M
05	Slide	Epdm Coated GGG40
06	Slide Nut	Brass
07	Shaft	SS 420-SS 316L
08	Shaft Centering Bed	Bronze
09	Cover Nut	Brass

• All connection elements (bolts, nuts, washers) are used as galvanized with 8.8 quality (A2-70 quality stainless steel is used optionally).

• All sealing elements (o-ring, gasket) are EPDM.



Pressure Class: PN10-PN16-PN25

Relevant Standards: TS EN 558+A1 series14-series15, DIN3202 F4-F5, TS EN 1171, TS EN 1092-2

Accessory: Electric actuator, gearbox, buckle kit

Paint: WRAS approved blue electrostatic epoxy powder paint (RAL 5005)

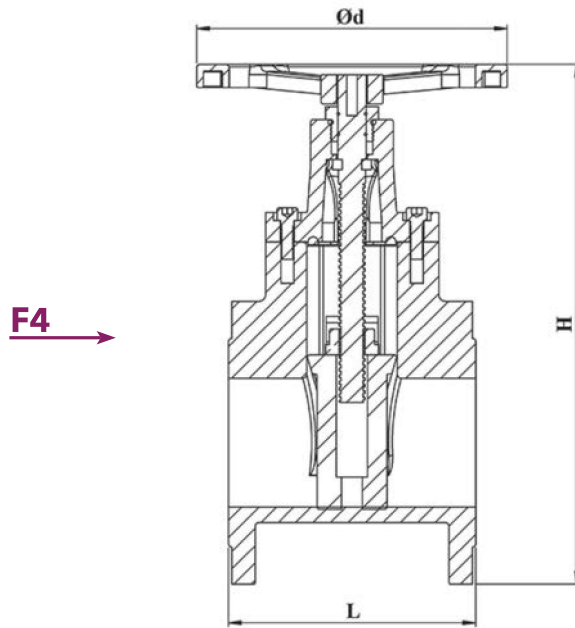

DN	50	65	80	100	125	150	200	250	300	350	400	450	500	600
L	150	170	180	190	200	210	230	250	270	290	310	330	350	390
H	200	230	280	310	325	380	510	630	630	700	810	1035	1150	1300
Ød	180	180	220	220	220	275	315	500	500	500	500	615	615	615

* Length measurements are given in " mm "

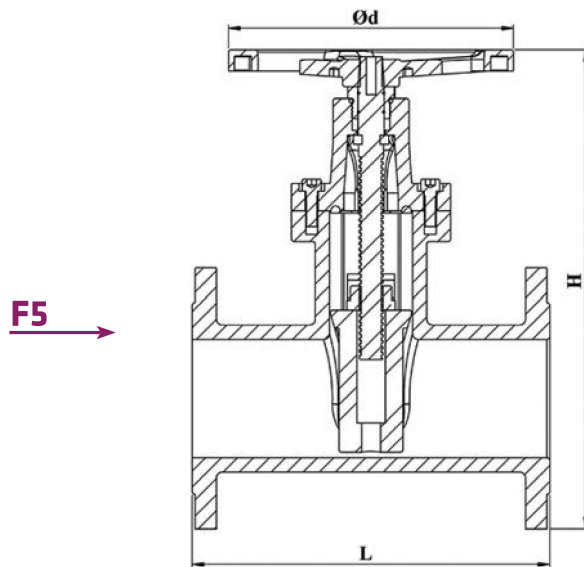

DN	50	65	80	100	125	150	200	250	300	350	400	450	500	600
L	250	270	280	300	325	350	400	450	500	550	600	650	700	800
H	200	230	280	310	325	380	510	630	630	700	810	1035	1150	1300
Ød	180	180	220	220	220	275	315	500	500	500	500	615	615	615

* Length measurements are given in " mm "